

Sold

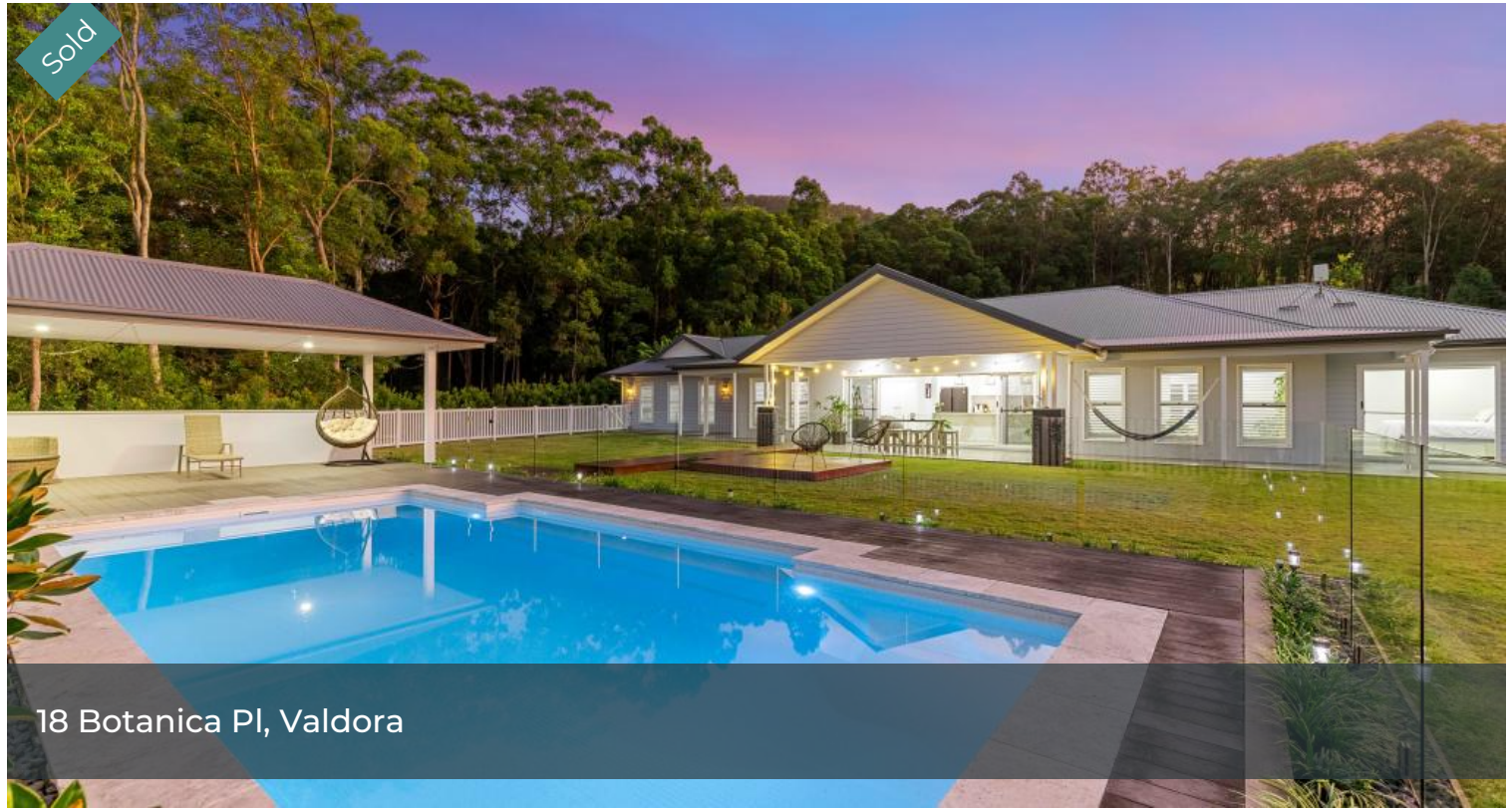

18 Botanica Pl, Valdora



Picture-perfect living for the modern family

Set high on an elevated grassy block and enveloped by beautiful bushland is this sensational Hamptons inspired home that makes the most of the breathtaking hinterland views on offer.

You'll enjoy all the space, peace and privacy paired with sweeping views that will leave you in awe each and every day that you come home.

The four-bedroom, two-bathroom layout is large and light-filled with a flexible design that uses the block perfectly and is sure to suit a wide range of families and lifestyles.

At the heart of this hilltop haven is the open-plan living, dining and the beautiful kitchen masterpiece, consisting of stone bench tops, long breakfast bar

🛏 4 🚿 2 🚗 8 🌊 📏

5,029 m²

Price SOLD for
\$2,000,000

Property Type Residential

Property ID 275

Land Area 5,029 m²

Agent Details

Kelly Rowling - 0437 443 013

Dan Rowling - 0421 456 776

Office Details

Rowling & Co Property

where you can take in the sprawling views of the kids playing in the yard and the hinterland beyond while you prepare dinner or entertain friends.

Rowling & Co Property

0437 443 013

ROWLING & CO

The inside effortlessly flows out to an expansive alfresco which offers a peaceful place to relax as the kids play in the fully fenced yard and stunning inground pool.

A laundry and central bathroom complete the layout while extra features include plantation shutters, ducted air-conditioning and ceiling fans throughout.

There is an attached over sized double garage as well as a large shed complete with car hoist which is perfect mancave for all the toys.

Located in a small prestigious estate at the end of a cul-de-sac street and only a short drive to Coolum surf beach and esplanade offering hotels, clubs, many various shops, coffee shops, cafes & A-Z of ones choice of amenities. It's all on offer here. Travel 10 minutes to Yandina township, Noosa is only half hour with beaches, local markets shopping centres, Airport less than half hour for international/domestic

What we love:

- Stunning open plan modern Hamptons style home with media room (281m²)
- 4 master sized bedrooms with walk in or built in robes
- 2 bathrooms main with free-standing bath & ensuite with double shower
- Oversized double garage
- 5029sqm (1.25 acres) fully fenced acreage with electric remote entry gate
- 9m freshwater swimming pool with large poolside cabana, large flat grassed yard & fire pit area
- Ducted reverse cycle air-conditioner zoned to all house and super electrical call-in system

- 2.7m high shadow line square set ceilings, LED lighting
- Plantation shutters, designer windows, glass sliding doors
- 12m x 12m x 5.5m high pitched shed with 2 x 4.5m high ROLLER DOORS and 4.5t car hoist. Bring the caravan, RV boats and all the boys' toys! side access door all key lockable
- 6kw Solar system with 29 panels reap the rewards of high discounted credited electricity bills
- Rainwater tanks: 2 x 34,000L to house & 2x 20,000L to shed
- Septic in-ground system-grey water

EXTRAS ****Beautiful landscaped gardens, glass pool fencing, sandstone boulder rocks for retaining walls, coloured concrete driveway, electric front slide gate

The above information provided has been furnished to us by the vendor/s. We have not verified whether or not that information is accurate and do not have any belief in one way or the other in its accuracy. We do not accept any responsibility to any person for its accuracy and do no more than pass it on. All interested parties should make and rely upon their own inquiries in order to determine whether or not this information is in fact accurate.

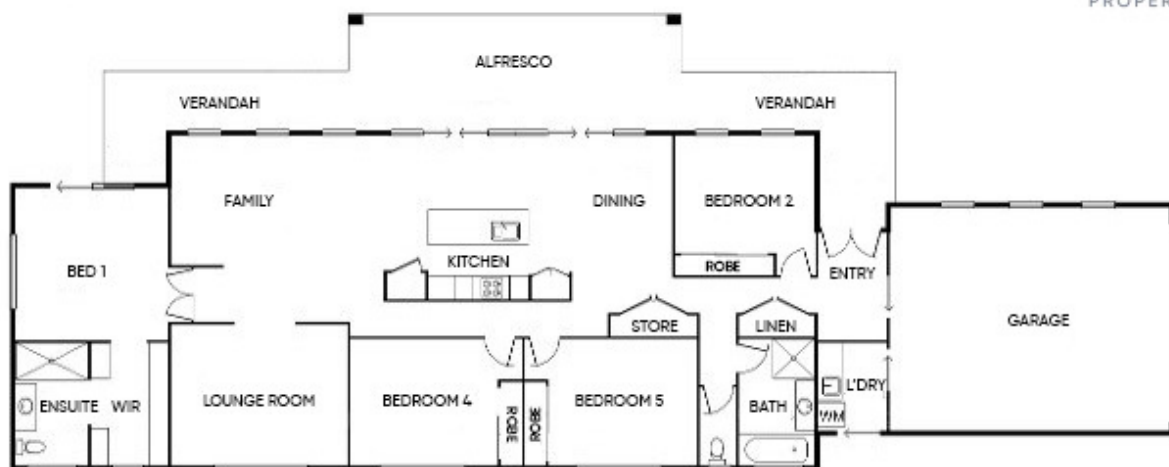

18 BOTANICA PLACE, VALDORA

