

Sold



Townhouse 23, 2 Photinia Cres, Mountain Creek



Spacious, Stylish and Set To Impress

Positioned perfectly in the popular Brightwater estate just minutes walk to the shops, school and tavern, this fantastic property is sure to tick all your boxes and priced perfectly.

This large townhouse has a double lockup garage and is packed with all the features you would want. Whether you are looking to live in and enjoy the area or after an investment, this spacious townhouse has a lot to offer.

Set over 2 levels and boasting a gorgeous neutral open floor plan; there is space for everyone.

Entertain friends and family in the private courtyard that flows perfectly from the beautiful kitchen which boasts gas cooking, loads of storage and a great breakfast bench.

On this lower level you will also conveniently find a

 3  2  2

Price	SOLD
Property Type	Residential
Property ID	54

Agent Details

Kelly Rowling - 0437 443 013

Dan Rowling - 0421 456 776

Office Details

Rowling & Co Property
0437 443 013

ROWLING & CO
PROPERTY

powder room and laundry so no need to go upstairs.

When you do make your way upstairs, you will find the three large bedrooms, all with built in robes and fans with the master having a walk in robe and ensuite.

Location is key with this home located just moments away from the Brightwater School, Aldi Shopping Complex and the Tavern. Mooloolaba beach, the Sunshine Coast University and Hospital are also all within 10 minutes drive. Key Features –

Two car remote garage Large private courtyard Security screens High ceilings and neutral colour scheme Pool in complex Ducted air conditioning and ceiling fans throughout Fantastic Rental Opportunity Onsite managers Low body corporate fees

The above information provided has been furnished to us by the vendor/s. We have not verified whether or not that information is accurate and do not have any belief in one way or the other in its accuracy. We do not accept any responsibility to any person for its accuracy and do no more than pass it on. All interested parties should make and rely upon their own inquiries in order to determine whether or not this information is in fact accurate.

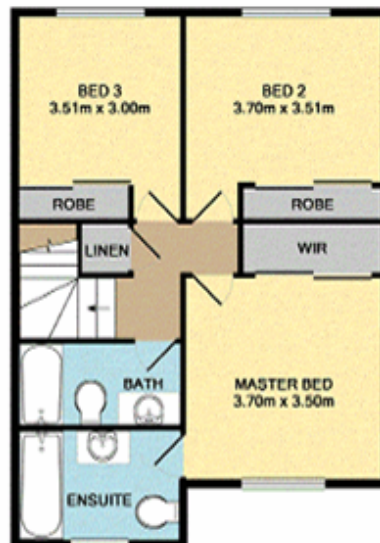
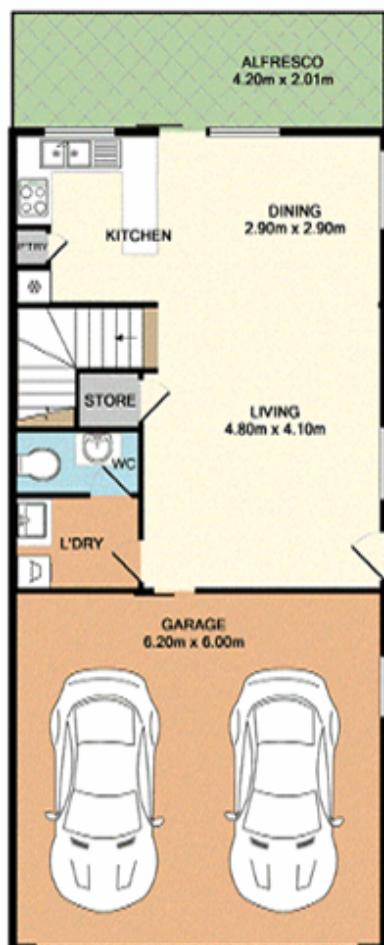

23/2 Photinia Crescent
Mountain Creek